

Beet cutter

Type BRS

Operator's manual ENG

Read carefully before use



Manufactured by: Flingk Machinebouw B.V.

Flingk Machinebouw B.V.
Retselseweg 11A
5473 HC Heeswijk-Dinther
The Netherlands

Tel: +31(0)85-0685613
info@flingk.com
www.flingk.com

All rights reserved. No part of this book may be reproduced, stored in a database or retrieval system, or published, in any form or any way, electronically, optically, by print, or any other means, without prior written permission from Flingk Machinebouw B.V.

Version: V01.20

First publication: 15 May 2019

Full translation of the original Dutch version.

PREFACE

Flingk Machinebouw's beet cutter is a high-quality machine that, depending on the type, can be used to be able to quickly and efficiently clean and cut a variety of products. Examine the technical specifications carefully to determine for which type of product your machine is suitable!

This manual has been prepared to enable you to obtain the best results from the Flingk beet cutter under safe working conditions, so please read and observe this operator's manual carefully before you start working and make sure you follow the instructions while working.

Although, the machine has been designed conform the EC certificate of conformity, always use extreme caution when operating the beet cutter. Read all instructions which are written in this operator's manual and those within the operators manual of the connected machine carefully and make sure you take them into account.

Because Flingk Machinebouw strives towards continuous product improvement, they reserve the right to change design and/or specifications without notice. This does not include an obligation to make changes to machines previously supplied.

If anyone does not fully understand every part of this operator's manual, please obtain further assistance by contacting the dealer from which this product was purchased or by contacting Flingk Machinebouw. Keep this manual available for reference whenever this product is being handled or used. Provide this manual to any new owners and/or operators.

Flingk Machinebouw wishes you a pleasant use!

Your supplier:



GENERAL SAFETY PRECAUTIONS

The Flingk beet cutter is designed for cleaning and cutting beets. Check within the technical specifications, before using the beet cutter, for which material your type of beet cutter is build. Do not use the beet cutter for materials it was not designed for!

The beet cutter may only be used by those persons which have read and understand the within this operator's manual specified safety and operating instructions. Only completely competent operators which now how to use the controls, the beet cutter's capabilities, dimensions and all safety requirements may operate the beet cutter.

Before using the beet cutter, check whether the combination of the beet cutter and connected machine is safe. Pay special attention towards the maximum lifting capacity and hydraulic power of the connected machine.

Use the beet cutter only for the purposes for which it was designed! Nobody, no persons, animals or other goods shall ride on/in the beet cutter during transport and/or operation.

The beet cutter is solely designed for use on private terrain, do not use or drive with it on the public road. In case you want to transport the beet cutter always adhere to the traffic, safety and environmental regulations and transport the machine in a responsible and safe manner.

Take care that nobody will be within the dangerous zone while operating, transporting or riding with the beet cutter. As an operator always ensure that nobody is within the reach of moving parts, within the operating area, or within close proximity of the machine while working.

Make sure nobody stays between the beet cutter and the cutting material while filling the beet cutter.

Maintenance and repair practices may only be performed by skilled specialists. Any work done on the hydraulic system should be done by Flingk Machinebouw or authorized dealers.

Never attempt to work on or repair the beet cutter while it is running! All power sources must be completely disengaged and the beet cutter should be placed in the forward position on a firm, level surface that is large enough to safely accommodate the beet cutter while repairing, cleaning or adjusting.

Never leave the connected machine unattended while the engine is running or with the beet cutter in an upright position. Always place the beet cutter in the forward position on a firm, level surface which is large enough to safely accommodate the beet cutter after use.



EG-DECLARATION OF CONFORMITY
according to annex II A of EC Machinery Directive 2006/42/EC

Manufacturer: Flingk Machinebouw B.V.
Located: Retselseweg 11A
5473 HC Heeswijk-Dinther
The Netherlands

hereby declares that the following machinery

Flingk beet cutter type: BRS

with the serial number effective from

Serial No. 87-19-3726

fulfils all of the relevant requirements of the EC Machinery Directive 2006/42/EG.

's-Hertogenbosch, 1 October 2017

On behalf of Flingk Machinebouw B.V.,

Dhr. Ing. N.C.W van den Berselaar

A handwritten signature in blue ink, appearing to be 'N.C.W. van den Berselaar', written over a faint circular stamp.

If any significant changes are made to this machine that could affect its safety or compliance with the regulations, its conformity must be reassessed and confirmed before the machine is put back into service.

TABLE OF CONTENT

Preface.....	3
General safety precautions	4
1 Safety instructions.....	7
2 Nameplate details	9
3 Lifting instructions.....	10
4 Product description.....	11
5 Technical specifications.....	11
6 Hydraulic flow chart	12
7 Commisioning.....	14
7.1 Mounting the linkage	14
7.2 Coupling the machine.....	15
7.2.1 Connection by means of a quick coupler system	15
7.2.2 Connection by means of a three-point linkage	16
8 Operating instructions	17
8.1 Loading the beet cutter	18
8.2 Riding with the beet cutter	18
8.3 Cleaning beets	19
8.4 Cutting beets	19
8.5 Emptying container	20
8.6 Storage of the beet cutter	20
9 Maintenance	21
10 Parts list.....	22
10.1 Type BRS	22
11 Warranty conditions	23
12 Notes	25

1 SAFETY INSTRUCTIONS

Read all safety decals and safety statements in all manuals prior to operating or working with this equipment.



DANGER!

This symbol by itself or with a warning word throughout this manual is used to call your attention to instructions involving your personal safety or the safety of others. Failure to follow these instructions can result in injury or death.

The machine has been marked with safety decals without text. For a safe use of the beet cutter make sure you understand and follow up the instructions on these decals. What is the danger, in which place does the danger occur and, very important, which safety instructions must be taken.

Be careful and be aware of the risks that are associated with the use of the beet cutter! The meaning of the decals are shown below.

- Carefully read operator's manual before handling the machine. Observe instructions and safety rules when operating.



- Stop engine and ensure it cannot be re-started during performance of work on the machine.



- High pressure fluid hazard!
Hydraulic fluid under pressure can penetrate the skin and cause serious injury or death. Always work warily and make sure all hoses and pipes are depressurized during maintenance and repair.



- Keep a safe distance!

Make sure that nobody is within the dangerous zone while operating. As an operator always ensure that nobody is within the reach of moving parts, within the operating area, or within close proximity of the machine while working.

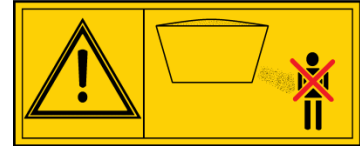

- Use the beet cutter only for the purposes for which it was designed! Nobody, no persons, animals or other goods shall ride on/in the beet cutter or be transported by the beet cutter in any case.



- Attention moving parts!

Stay clear of rotating and moving parts. Maintain a safe distance and make sure nobody is able to come in contact with the moving parts while operating. Never attempt to work on or repair the beet cutter while it is connected to the power source.



- Danger for crushing!

When connecting the beet cutter, make sure nobody is between the beet cutter and the machine.



- Beware of explosion hazard.

The accumulator is under high pressure. Beware of damage.



2 NAMEPLATE DETAILS

The nameplate of the Flingk beet cutter is located in the front of the machine, in the upper right. In case of correspondence, kindly state the type- and serial number of your machine..



- A. Machine :
- B. Type :
- C. Serial number :
- D. Year of build :
- E. Weight :
- F. F1 Max. flow (Q_{max}) [l/min] :
- G. F1 Max. pressure (P_{max}) [bar] :
- H. F2 Max. flow (Q_{max}) [l/min] :
- I. F2 Max. pressure (P_{max}) [bar] :
- J. Voltage [V] :
- K. Current [A] :

3 LIFTING INSTRUCTIONS

To move the Flingk beet cutter without it being coupled to a compatible machine, you need to use the two lifting eyes as shown in the drawing below (the beet cutter in the picture may vary from the beet cutter that you use). Always check the lifting capacity of the lifting gear. The weight of the Flingk beet cutter is stated on the name plate and is included in the “Technical specifications” section of this instruction manual.

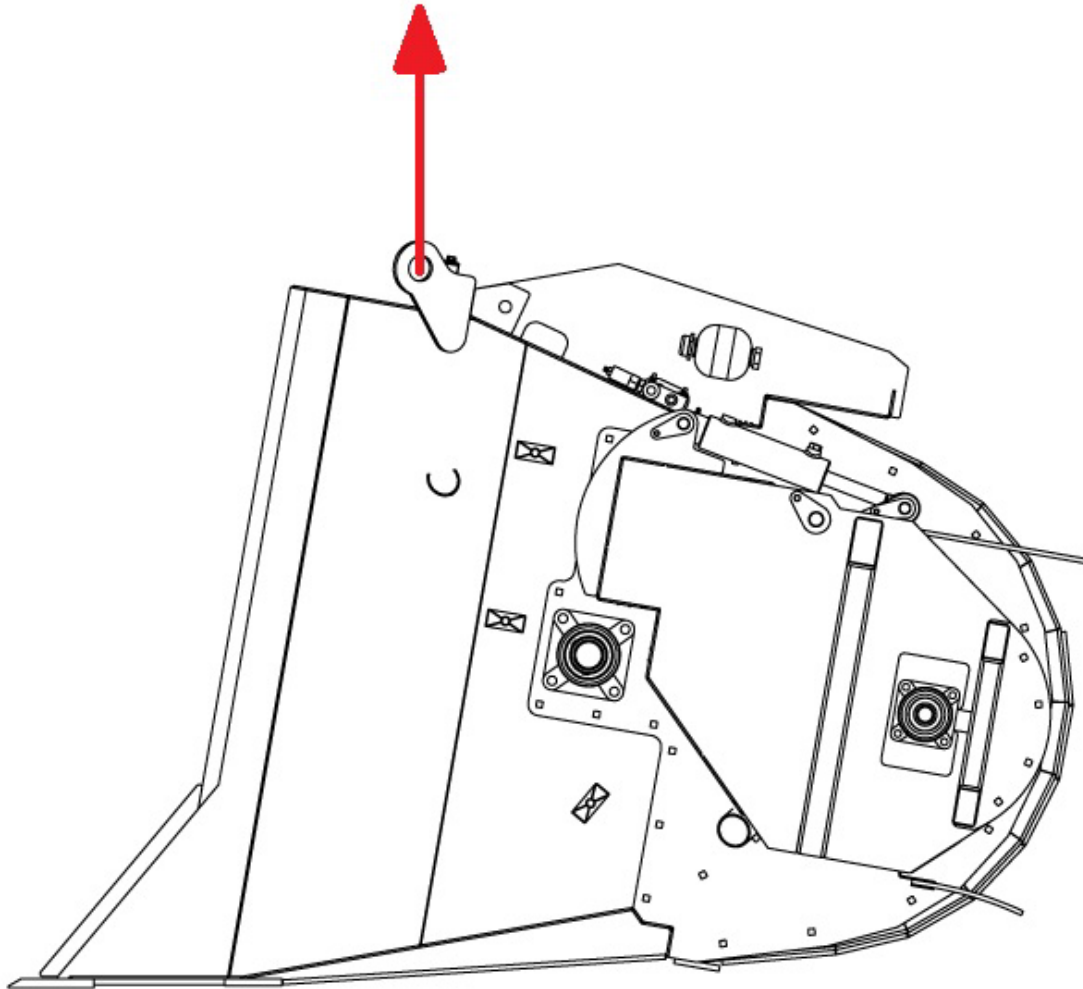

4 PRODUCT DESCRIPTION

The Flingk beet cutter is a high-quality machine for quickly and efficiently cleaning and cutting beets. The beet cutter is designed as a single type (BRS) catering for a variety of volumes. The BRS is available in various versions, which are set out in section 5 of this manual. Using the beet cutter, it's easy to clean and cut beets. Water sprayers can be mounted for faster and enhanced cleaning. The bin on the bottom of the machine ensures that no sand or other dirt falls onto the feed passage or yard.

5 TECHNICAL SPECIFICATIONS

The Flingk beet cutter is suitable for cleaning and cutting beets. The table below provides a full overview of the different versions with the associated technical specifications.

*Technical specifications Flingk beet cutter **Type BRS***

Type	BRS 1000	BRS 1500	BRS 2000
Suitable for	Bieten	Bieten	Bieten
Width (mm)	1500	2100	2280
Content (l)	1000	1500	2000
Weight ¹ (kg)	850	940	1030
Max. loading weight	500	625	775
Minimal required capacity	oil 30 L/min 175 bar	30 L/min 175 bar	50 L/min 175 bar
Maximum oil capacity	60 L/min 225 bar	60 L/min 225 bar	75 L/min 225 bar

¹ Weight exclusive linkage, weight may vary depending on the version of the machine and linkage.
Shovel-linkage +30-100 kg
Three-point linkage single cylinder +30-100 kg
Three-point linkage double cylinder +150 kg

6 HYDRAULIC FLOW CHART

A number of hydraulic power configurations are possible for this type of beet cutter and version. The standard power configurations that can be supplied are set out below.

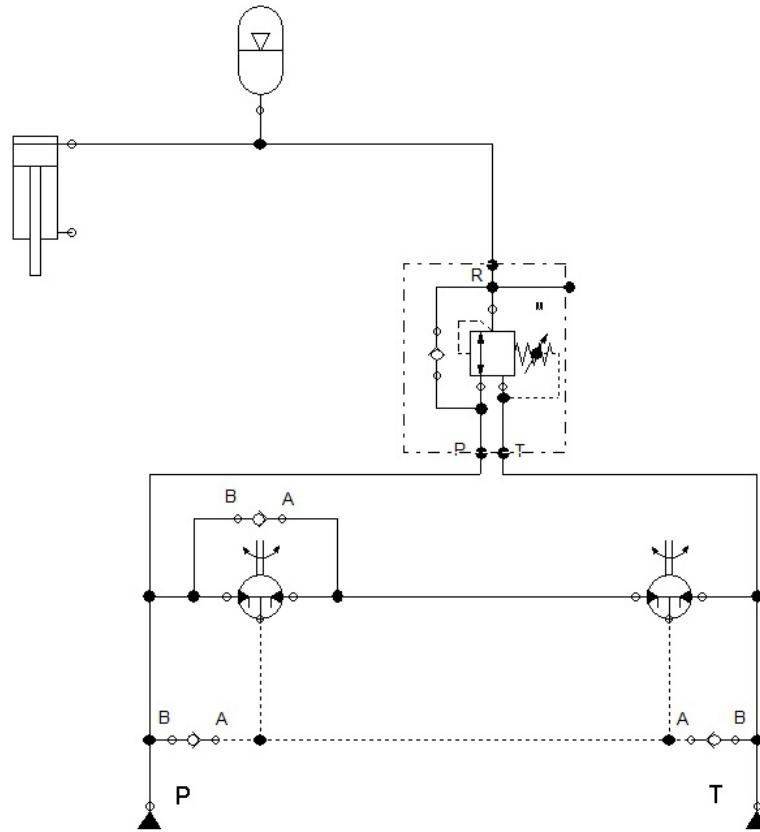

*Hydraulic flow chart type BRS
Standard version*

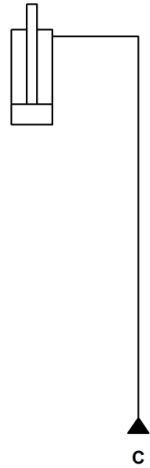

*Hydraulic flow chart three-point linkage²
Single cylinder*

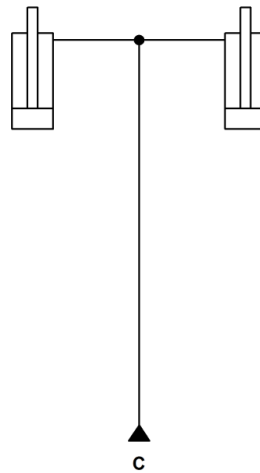

*Hydraulic flow chart three-point linkage²
Double cylinder*



Before maintenance of the hydraulic system disconnect the hoses of the connected machine and make sure that the hoses are depressurized!

² In case of an 'additional valve' both; the tractor linkage and the beet cutter hydraulics are connected after the manifold. In this case only 1 double regulating valve is required.

7 COMMISIONING



The beet cutter may only be used by individuals, who are familiar with the operating, maintenance and safety instructions set out in this instruction manual.

Before mounting the beet cutter onto the machine, first check whether the beet cutter and machine combination is safe. In so doing, pay particular attention to the machine's maximum lifting capacity and hydraulic capacity. The details of the beet cutter are stated on the name plate and in the technical specifications.

For more information about the safety of the combined unit, consult the machine's operating and safety instructions.

7.1 MOUNTING THE LINKAGE



Use only the linkage made and delivered by Flingk Machinebouw to connect the beet cutter and the machine.



Mount the linkage with the original fasteners delivered by Flingk Machinebouw.

The linkage should be mounted on the two square tubes that are welded on the beet cutter. The fixing materials are delivered with the linkage.

1. Turn the fasteners hand-tight, with the linkage at about the right place.
2. Measure, when needed, the size of the linkage.
3. Also measure the width to the outside of the mounting sleeves and make sure the size is the same on both sides so that the coupling is centred.
4. Tighten all fasteners, ensure that locknuts are used.
5. Eventual adjust the stop to the driving machine.
6. Before taking the machine in use, try to fit the linkage to the driving machine to ensure the connection fits properly.

7.2 COUPLING THE MACHINE

The Flingk beet cutter can be connected by means of the three-point linkage of a tractor or the quick coupler system. Follow depending on the type of connection the following instructions:

1. connection by means of a quick coupler system
2. connection by means of a three-point linkage

7.2.1 Connection by means of a quick coupler system



Before using the beet cutter, check whether the combination of the beet cutter and the connected machine is safe. Pay special attention towards the maximum lifting capacity and hydraulic power of the connected machine.



Make sure you never connect the drain line (red dust cap) at a pressure outlet!

Always check before connecting the beet cutter whether the connection on the beet cutter is appropriate for the connection on the machine.

Pay special attention towards the distance between the holes and pins both, horizontally and vertically as well as the diameters of the different holes and pins. Before connecting the beet cutter always check the operator's manual of the machine and/or of the quick coupler system.

1. The beet cutter should be placed in the forward position, with the mounting points facing upwards, on a firm and level surface.
2. Follow strictly the instructions as described within the operators manual of the quick coupler system to attach the beet cutter towards the machine.
3. Check whether all connections are connected and secured properly.
4. Connect the hydraulic hoses. Connectors A and B (yellow/blue) should be coupled to the pressure ports on the connected machine (see hydraulic flow chart). Make sure the drain line is also connected well, it must not be pressurized during operation. Be aware and prevent unforeseen oil spills, think about the natural environment.
5. Check the movement and clearance of all hydraulic hoses, make sure they are of sufficient length and will not be wedged during operation.

7.2.2 Connection by means of a three-point linkage



Before using the beet cutter, check whether the combination of the beet cutter and the connected machine is safe. Pay special attention towards the maximum lifting capacity and hydraulic power of the connected machine.



Make sure you never connect the drain line (red dust cap) at a pressure outlet!

For connecting the Flingk beet cutter by means of a three-point linkage follow the next instructions:

1. The beet cutter should be placed in the upright position, with the mounting points facing forward, on a firm and level surface.
2. Make sure all connections are greased sufficiently before connecting the beet cutter.
3. To connect the beet cutter follow all instructions as provided within the operator's manual of the three-point linkage and/or the connected machine. Make sure you use the proper implements, these should fit accurately on the beet cutter.
4. Make sure all connections are secured properly
5. Connect the hydraulic hoses. Connectors A and B (yellow/blue) should be coupled to the pressure ports on the connected machine (see hydraulic flow chart). Make sure the drain line is also connected well, it must not be pressurized during operation. Be aware and prevent unforeseen oil spills, think about the natural environment.
6. Check the movement and clearance of all hydraulic hoses, make sure they are of sufficient length and will not be wedged during operation.

8 OPERATING INSTRUCTIONS



The type of Flingk beet cutter is only suitable for beets. Use the beet cutter exclusively for the purpose for which the machine has been designed.

Before using the Flingk beet cutter, pay carefully attention to the following rules:

- Make sure that before using the beet cutter the safety/warning stickers are clean and legible.
- Make sure that the coupling between the tractor and the beet cutter is properly secured. To do so, consult the tractor manual.
- Before use, always check the entire beet cutter and the hydraulic hoses for possible wear and tear and faults. The coloured dust caps (yellow/blue/red) should also be fitted on the hydraulic couplings
- The beet cutter may only be operated from the driver's position in the tractor.
- In the unlikely event of bridging in the bin, place the beet cutter in its upright position on a solid and stable surface and switch off the tractor engine before attempting to unblock the mulch. Watch out for the blades! Use a tool such as a rake or shovel to unblock the mulch.
- In the unlikely event that the mixing roller or cutting roller becomes blocked, place the beet cutter in a horizontal position on a solid and stable surface and switch off the engine of the tractor before attempting to release the beet from the mixing roller or cutting roller. Use a tool such as a rake or shovel to unblock the beets.
- After the machine has jammed due to an external object, have the entire machine inspected by your dealer before continuing to use it.
- Wear personal protective equipment when carrying out cleaning works.

8.1 LOADING THE BEET CUTTER

The beet cutter is filled when in its horizontal position, with the blade flat on the ground, as indicated in the drawing below (1). Advance the bucket into the beets so that the bucket is filled and then rotate the bucket to its vertical position (2).



Make sure that when filling the bucket, nobody is between the mulch and the beet cutter.

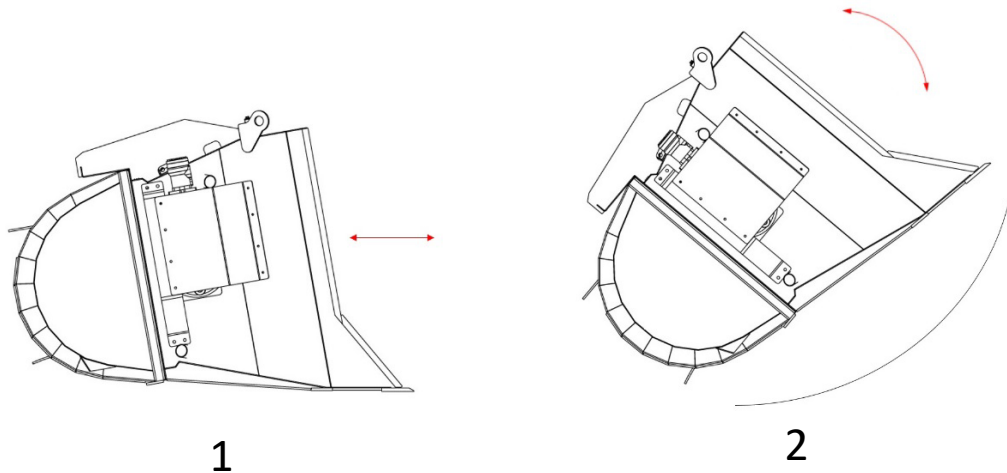

8.2 RIDING WITH THE BEET CUTTER

Make sure that when driving with the beet cutter, the bucket is kept as close to the ground as possible in its vertical position. This prevents any potential imbalance and improves visibility of whatever is in front of or behind the beet cutter.



The beet cutter is only suitable for use on private property. Driving on the public highway with this piece of machinery is not permitted. Always transport the machine in a safe and responsible manner, that is permitted on the public highway.

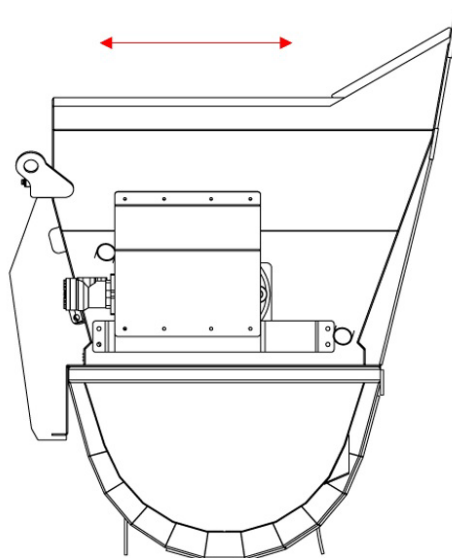

8.3 CLEANING BEETS



Avoid unsafe situations, maintain a distance from moving parts and, as the operator, make sure that you always have a good overview of what is within the machine's working area.



Make sure that there are no people or animals within the machine's working area.

When cleaning, proceed as follows:

- When cleaning, make sure that the bucket is always kept in its vertical position.
- Before you start cleaning, have a good look to make sure that there are no people or animals within the machine's working area.
- To clean the beets, the mixing roller should rotate in a clockwise action (as you look at it standing on the cutting box side).
- Sand and any other dirt falls into the bin below the beet cutter.

8.4 CUTTING BEETS



Avoid unsafe situations, maintain a distance from moving parts and, as the operator, make sure that you always have a good overview of what is within the machine's working area.



Make sure that there are no people or animals within the machine's working area.

When cutting, proceed as follows:

- When cutting, make sure that the bucket is always kept in its vertical position.
- Before you start cutting, have a good look to make sure that there are no people or animals within the machine's working area.
- If you want to unload the beets directly into the feeding passage, then keep the cutting box on the side of the feeding passage. Start cutting at the same time as driving slowly in line with the feeding passage, maintain a steady rotational speed and travel speed to ensure an even distribution and cutting result of the beets.
- If you want to unload the beets into the mixer wagon or some other place, then position the cutting box above the location or machine into which you want to unload the beets. Start cutting and maintain a steady rotational speed for a uniform cutting result of the beets.

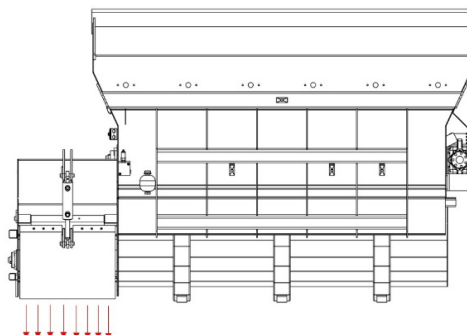

8.5 EMPTYING CONTAINER



Avoid unsafe situations, maintain a distance from moving parts and, as the operator, make sure that you always have a good overview of what is within the machine's working area.



Make sure that there are no people or animals within the machine's working area.

When emptying the bin, proceed as follows:

- Before you start emptying, have a good look to make sure that there are no people or animals within the machine's working area.
- Position the beet cutter above the location where you wish to empty it.
- Continue to rotate the beet cutter until the sand and other dirt is unloaded.

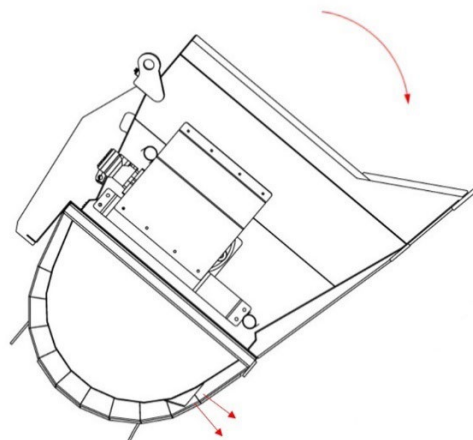

8.6 STORAGE OF THE BEET CUTTER



Make sure that the beet cutter is not exposed to extreme weather conditions and, when it is not in use, store the beet cutter away in a sheltered environment, protected from rain, snow and ice.

Always place the beet cutter in a horizontal position on a solid, stable surface. Check whether the hydraulic couplings are hanging loose. The coloured dust caps (yellow/blue) should also be fitted on the hydraulic couplings.

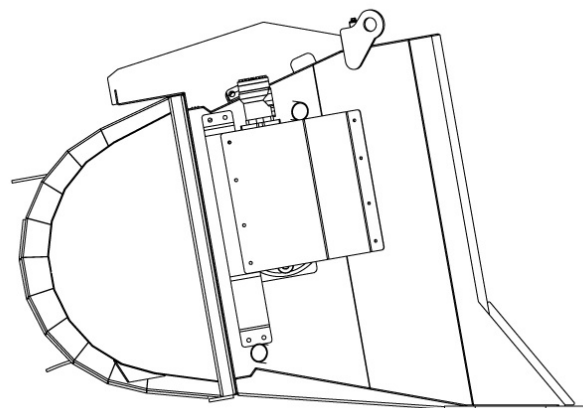

9 MAINTENANCE



Maintenance and repairs may only be carried out by staff, who have received adequate technical training, using the correct tools.



Maintenance, repairs and cleaning works may only be carried out when the hydraulic hoses are uncoupled and when the beet cutter is placed in its horizontal position on a solid and flat surface.



Always have repairs to the hydraulic system carried out by Flingk Machinebouw or your dealer.



Make sure that the beet cutter is not exposed to extreme weather conditions and, when it is not in use, store the beet cutter away in a sheltered environment, protected from rain, snow and ice.



Only replace components, which are supplied by Flingk Machinebouw or your dealer.

The machine should be maintained as follows:

- Regularly check the front blade for damage and wear and tear.
- Regularly check the mixing roller and cutting roller for damage and wear and tear. The mixing roller and cutting roller should not be allowed to turn against anything.
- Regularly check the hydraulic system for damage and wear and tear. The sheathing of the hydraulic hoses may not be damaged under any circumstances.
- Lubricate all bearings every six months or every 30 hours of use.
- Replace the gearbox oil after the first 50 hours of use. Use SAE 80W90 transmission oil.

10 PARTS LIST

10.1 TYPE BRS

- Bij het bestellen van onderdelen graag de volgende dingen doorgeven:
Het serienummer van de machine,
De naam van de tekening,
Het positienummer in de tekening.
- When ordering parts, please give the following items:
The serial number of the machine,
The name of the drawing,
The item number in the drawing.
- Bei der Bestellung von Ersatzteile, bitte geben Sie die folgenden Punkte:
Seriennummer der Maschine,
Der Name der Zeichnung,
Die Positionsnummer in der Zeichnung.

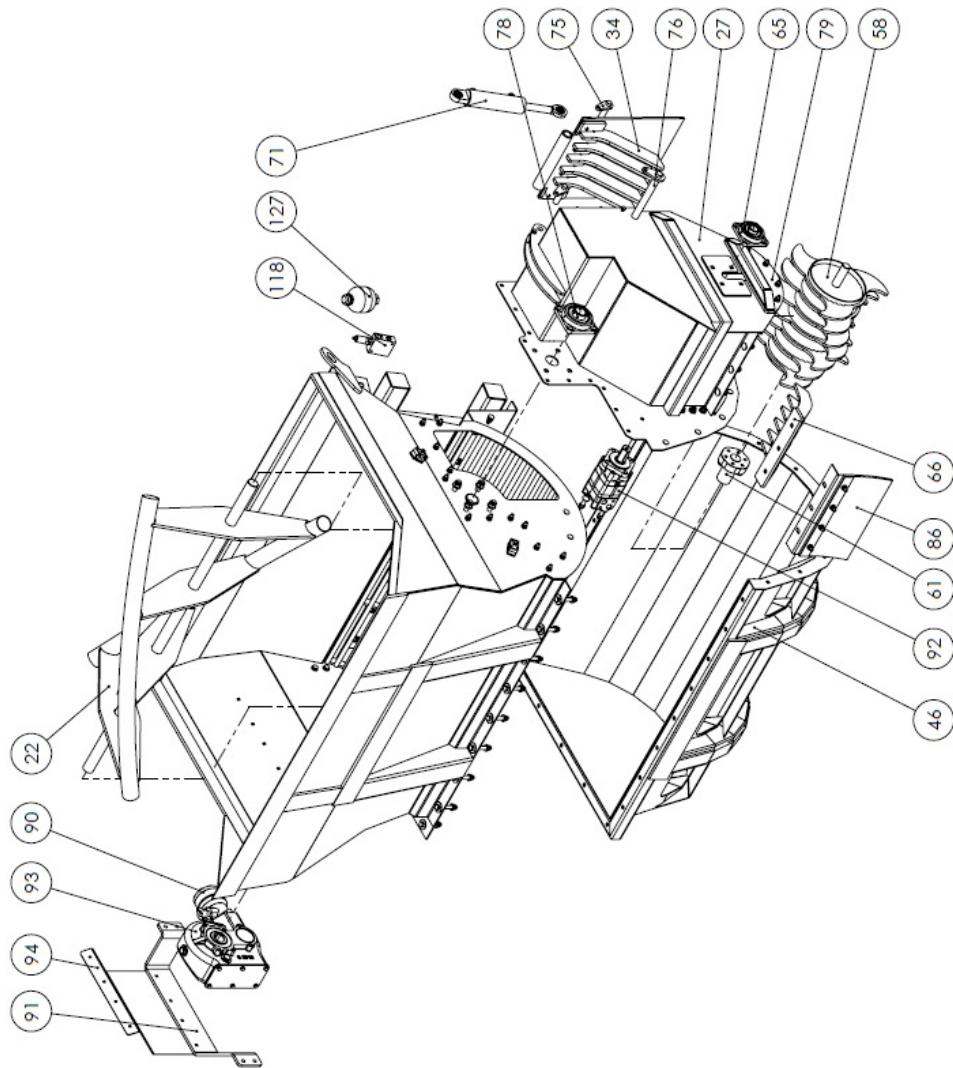

Drawing: BRS 01

11 WARRANTY CONDITIONS

Unless mentioned otherwise, the guarantee conditions as indicated within the METAALUNIE CONDITIONS, formerly referred to as the SMECOMA CONDITIONS, as published by the Koninklijke Metaalunie will be applied.

The clauses below are taken from this METAALUNIE CONDITION as issued by the Koninklijke Metaalunie in 2019.

Article 14: Warranty and other claims

- 14.1 Unless otherwise agreed in writing, the Contractor guarantees the proper execution of the agreed performance for a period of six months after delivery or completion, as detailed in the following paragraphs.
- 14.2 If the parties have agreed to deviating guarantee conditions, the provisions of this article will remain in full force, unless this is in conflict with those deviating guarantee conditions.
- 14.3 If the agreed performance has not been executed properly, the Contractor will decide within a reasonable period of time whether it will still perform the work properly or credit the Client for a proportionate part of the contract amount.
- 14.4 If the Contractor opts to still execute the performance properly, it will determine the manner and time of execution. The Client must in all cases offer the Contractor the opportunity to do so. If the agreed performance (also) included the processing of material provided by the Client, the Client must supply new material at its own expense and risk.
- 14.5 The Client is responsible for sending parts or materials that are to be repaired or replaced by the Contractor to the Contractor's business location.
- 14.6 The following are for the Client's account:
- a. all transport or shipping costs;
 - b. costs for dismantling and assembly;
 - c. and subsistence expenses and travel time.
- 14.7 The Contractor is only obliged to implement the guarantee if the Client has fulfilled all its obligations.
- 14.7 a. The guarantee does not cover defects that are the result of:
- normal wear and tear;
 - improper use;
 - lack of maintenance or maintenance carried out incorrectly;
 - installation, assembly, modification or repairs carried out by the Client or third parties;
 - faulty or unsuitable goods originating from or prescribed by the Client;
 - faulty or unsuitable materials or tools used by the Client.
- b. No guarantee is given for:
- goods delivered that were not new at the time of delivery;

- inspections and repairs carried out on goods owned by the Client;
- parts that are subject to a manufacturer's guarantee.

14.8 The provisions of paragraphs 3 to 8 of this article apply by analogy to any of the Client's claims based on breach of contract, non-conformity or any other basis whatsoever.

FLINGK

Machinebouw

